

INVESTMENT CASTING METAL STAMPING MACHINING

we are committed to casting
the high quality product for our customers



For more information, visit www.luenhingmetal.com



We provide the one - stop service
Specialise in Stainless Steel Prodcuts & Metal Products

造壓工 鑄沖加 密屬械 精金機

我們致力為客戶鑄造高品質的產品

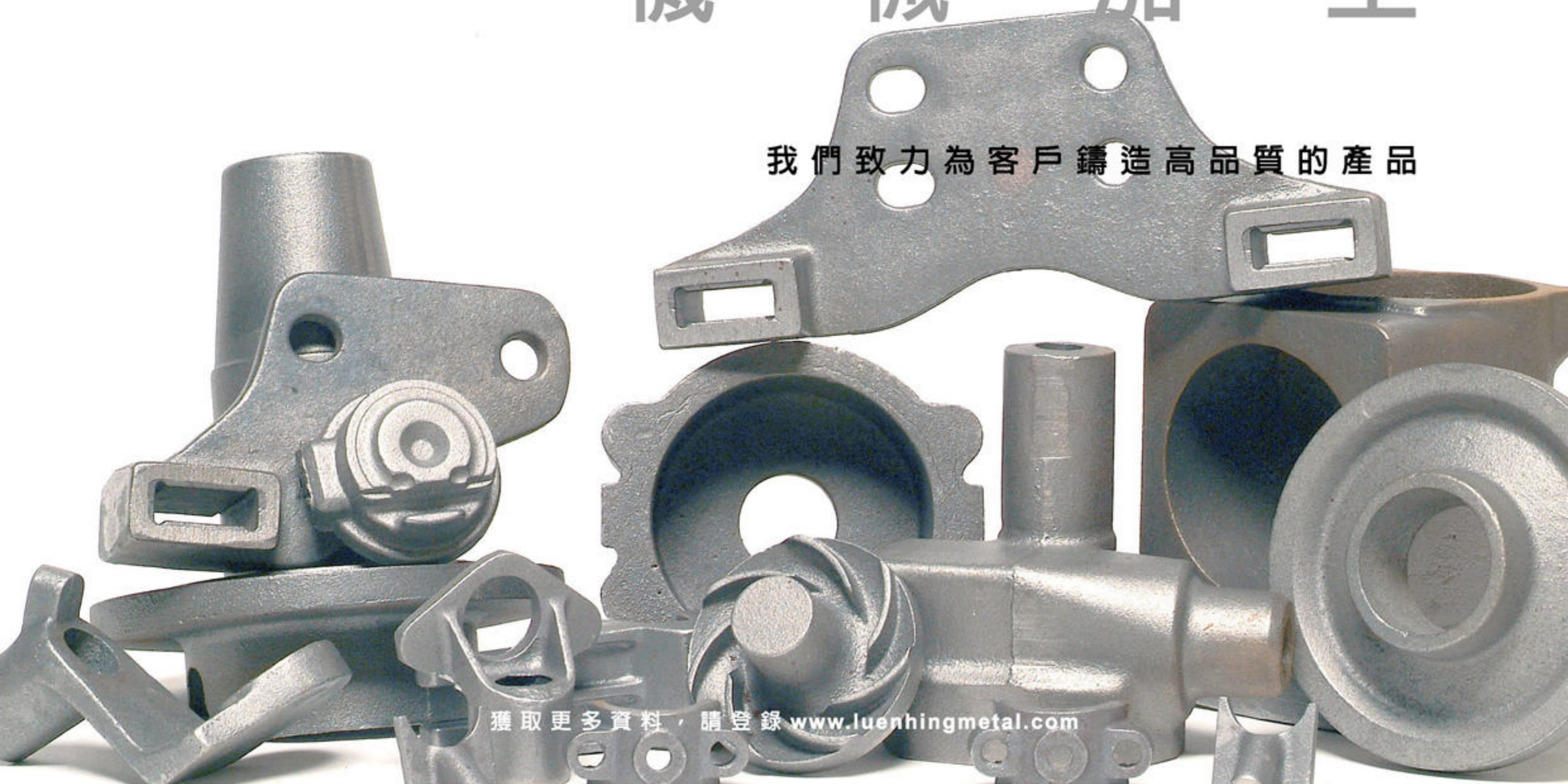

獲取更多資料，請登錄 www.luenhingmetal.com



聯興
金屬製品廠

本公司提供一站式的服務
專業生產不銹鋼產品及金屬產品

BACKGROUND - 公司背景

Luen Hing Metal Manufactory established in 1972, is a manufactory offering multiple services in **Investment Casting** (Lost Wax Casting), **Metal Stamping**, **Machining Process**, and **Finishing** hardware as well as **Assembly**.

Our products are widely used in various kind of industries, such as **machinery manufacturing**, **automotive production**, **home supplies**, and **construction industry**. In order to provide quality services, and improve high quality product, we continue to acquire more advances equipment, purchase chemistry analyzer and continuous improvement of production technology to meet the requirements of different customers.

The company is recognized for its high professional standards accumulated through years of experience.

We work towards long-term co-operations with our customers, enhancement in quality and technology and catering to special customer needs. We endeavor to carry forward the spirit of putting quality and customers foremost, as it is essential to winning customer confidence.

Our dedication to service plays a key role in the success of our customers.

聯興金屬製品廠創立於1972年，專營**精密鑄造**（失蠟鑄造），**沖壓**，**機械加工**，**打磨**及**裝配**等業務。

我們的產品受廣泛應用於各種行業，包括**機械製造**，**汽車生產**，**家具用品**及**建築行業**。為了提供優質服務，及提高產品質量，我們不斷添置先進設備，購置化學分析儀，以及不斷改善生產技術，以迎合不同客戶的要求。

此外，我們亦注重產品設計，嚴格控制生產成本，藉以提高本身的競爭能力。公司憑藉豐富的營運經驗，已達致較高的專業水平。我們殷切期望與客戶成為長遠及良好的合作夥伴，透過提供優質而價廉的產品，滿足客戶的需求。

我們致力以品質及客戶為先，因而贏取客戶對我們的信心，亦藉此協助顧客建立成功的事業。



MACHINERY PARTS
機械零件

PURPOSE - 目標

We aims to provide quality products with customer's specific requirements.

Our commitment begins with using the best available equipment, materials, people, processes, and technology to manufacture your investment casting products.

Our goal is to produce on time, cost effective, precision investment cast parts that offer your greater opportunities to improve your product design, your cost, and part performance.

我們目標在於提供各類優質產品以迎合客戶的各種要求。

我們的承諾始於使用最佳設備，材料，團隊，工序和技術制出您的精密鑄造產品。

我們的目標是準時生產，成本效益，精準的精密鑄件提供更多改善您的產品設計，成本和部分



CONSTRUCTION ACCESSORIES
建築配件

FACILITIES - 機械設備

METAL STAMPING & MACHINING FACILITIES

金屬沖壓及機械加工設備

- 1.POWER PRESS/ PUNCHING MACHINE
- 2.HEAVY DUTY MACHINE

沖床
重型油壓機

- 3.DRILLING MACHINE
- 4.GENERAL LATHE
- 5.MILLING MACHINE
- 6.TAPPING MACHINE
- 7.GRINDING MACHINE
- 8.ELECTRO-DISCHARGE MACHINE
- 9.WIRE CUT MACHINE
- 10.FURNACE(QUENCHING OIL)
- 11.WELDER
- 12.CNC Lathe

鑽床
車床
銑床
攻牙床
磨床
電蝕火花機
數控線割機
琺氣爐
接焊機
數控車床

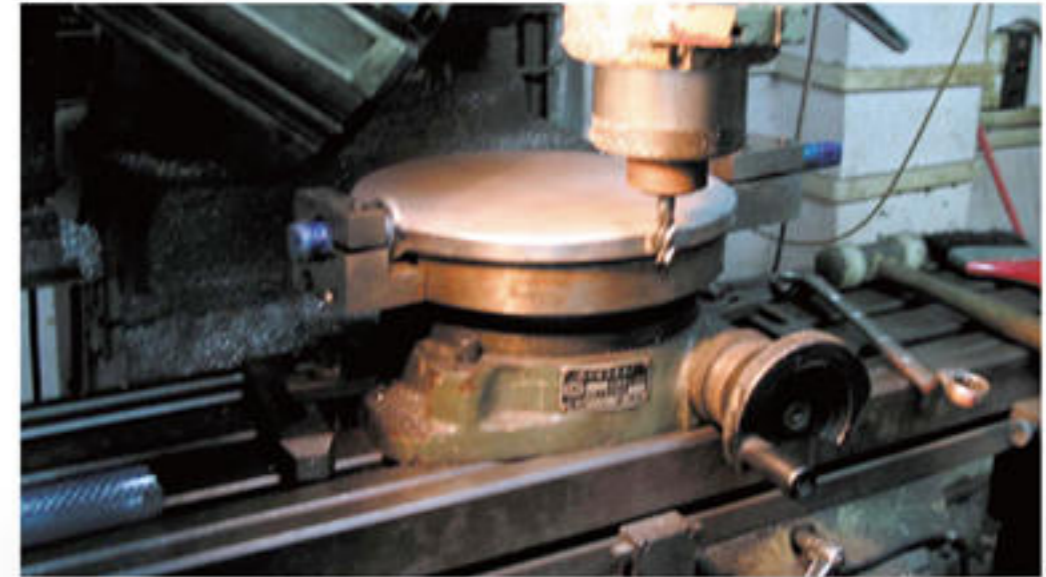

INVESTMENT CASTING FACILITIES

精密鑄造設備

- 13.WAX INJECTION MACHINE
- 14.INCUBATOR
- 15.STEAMING BOILER
- 16.MELTING FURNACE
- 17.TUMBLING MACHINE.
- 18.VERTICAL STEEL BLASTING MACHINE
- 19.HORIZONTAL STEEL BLASTING MACHINE
- 20.CUTTING MACHINE
- 21.WELDING MACHINE BY HAND
- 22.POWERFUL SAND BLASTING MACHINE
- 23.HORIZONTAL FINISHING MACHINE
- 24.ACID FINISHING WORKSHOP

射蠟機
衡溫室
蒸爐
熔煉爐
振機
直立吊噴機
臥式滾丸機
切割機
人手焊機
強力噴沙機
臥式打磨機
酸洗工場



FINISHING FACILITIES

加工設備

- 25.SAND BLASTING MACHINE
- 26.ULTRASONIC CLEANING MACHINE
- 27.MATERIAL WASHING MACHINE
- 28.POLISHING ROLLING MACHINE
- 29.ELECTRIC ROASTER
- 30.HORIZONTAL SURFACE FINISHING MACHINE
- 31.CLEANING WORKSHOP

玻璃沙噴機
超聲波清洗機
洗料機
滾桶拋光機
烘爐
臥式拉沙機
清洗工場



MEASURING FACILITIES

測量儀器

- 32.OVERHEAD PROJECTOR
- 33.DIRECT READING SPECTROSCOPE
- 34.SCLEROMETER

投影儀
光譜分析儀
硬度計



ALLOY SELECTION - 合金種類

低合金鋼 LOW ALLOY STEEL	奧氏體不銹鋼 AUSTENITIC STAINLESS STEEL	馬氏體不銹鋼 MARTENSITIC STAINLESS STEEL	鐵素體不銹鋼 FERRETIC STAINLESS STEEL	碳鋼 CARBON STEEL
1020 1045 1050 1095 4130 4140 4150 4340 6150 8620 8650	303 304,304L 316,316L 316/ NonMag CF-8,CF-3 CF-8M,CF-3M 330 347 20-CB3 Alloy20,CN-7M CF10-SMnN	410 416 420 431 15-5PH 17-4PH 440A 440C CA-6NM	409 430 436 446	15C 25C 35C 45C



INVESTMENT CASTING PROCESS - 精密鑄造工序



STAINLESS STEEL PRODUCTS - 不銹鋼產品



LEVER HANDLE / 把手



MARINE PART / 船舶用品



LIGHTING / 燈具



ELBOW VALVE / 彎頭閥門



MACHINERY PARTS / 機械零件

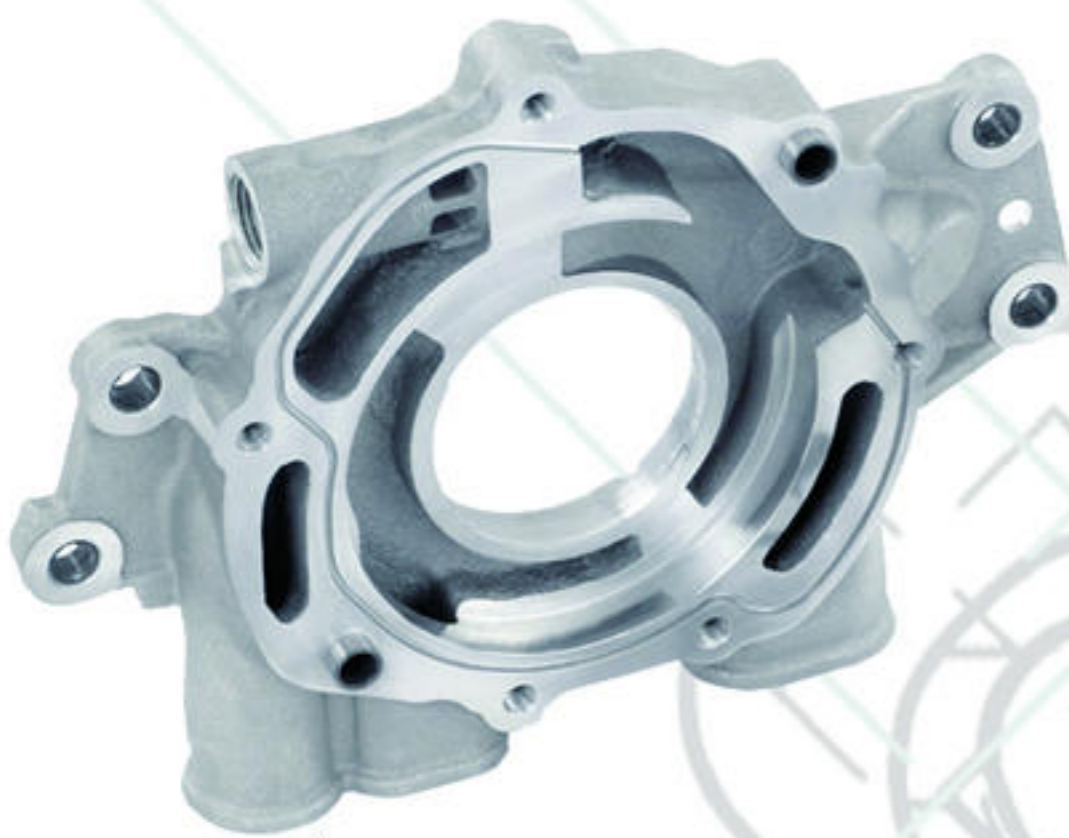

AUTO PART / 汽車零部件

GAS COOKTOP / 爐架



WATCHBANDS / 錶帶